

REV.	DESCRIPTION	DATE
A	RELEASED	2019/04/15

NOTE:

- MECHANICAL PERFORMANCE:
 - 1-1. INSERTION FORCE: 0.5~2.0kgf.
 - 1-2. REMOVAL FORCE: 0.8kgf~2.0kgf.
 - 1-3. DURABILITY: 10000 CYCLES.
- ELECTRICAL PERFORMANCE:
 - 2-1. CURRENT RATING:3.0A
VOLTAGE RATING:5.0V
 - 2-2. LLCR:
VBUS & GND PINS AND OTHER PINS:
40mΩ/PIN MAX.
SHIELD: 50mΩ/MAX.
LLCR MAX. CHANGE OF ALL PINS: 10mΩ.
 - 2-3. INSULATION RESISTANCE: 100MΩ MIN.
 - 2-4. DIELECTRIC WITHSTAND VOLTAGE,
AC 100V FOR 1 MINUTE.
- ENVIRONMENTAL PERFORMANCE:
 - OPERATING TEMPERATURE: -25°C~+85°C.
- IR REFLOW:
 - THE PEAK TEMPERATURE ON THE BOARD SHALL BE MAINTAINED FOR 10 SECONDS AT 260°C.

PART NUMBER INFORMATION :

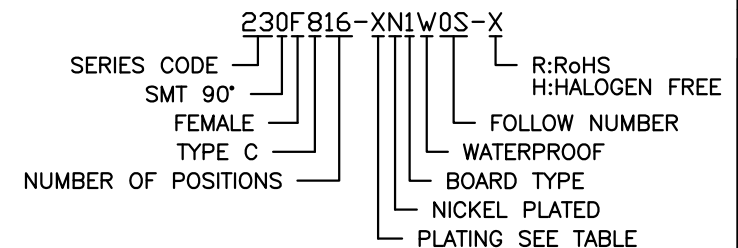

DESCRIPTION OF PLATING ON TERMINALS			
NO.	EXPLAIN	NO.	EXPLAIN
0	GOLD FLASH	3	GOLD 15u"
1	GOLD 5u"	4	GOLD 20u"
2	GOLD 10u"	6	GOLD 30u"

TOLERANCE .0=±0.30 .00=±0.10 .000=±0.05 ANG.=±5°	DRAWER ***** CHECK	INMO 东莞市英墨电子有限公司 INMO Electronics Co.,Ltd NAME TYPE C 16P L7.85 WATERPROOF DRAW NO. R230F816-XN1W0S-X		
	APP'D			
PRODUCT SPEC. _				
UNITS : mm	SCALE NONE	SIZE A4	SHEET 1 OF 1	REV. *

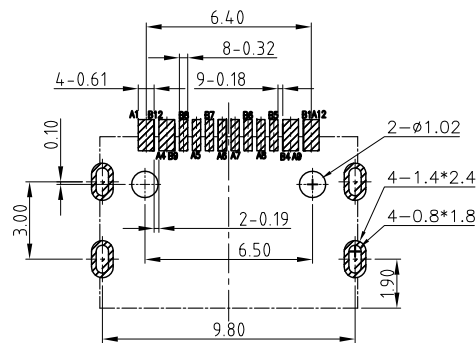

RECOMMEND PCB LAYOUT TOP VIEW
TOLERANCE: ±0.05

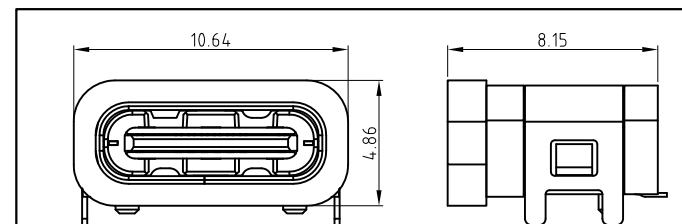
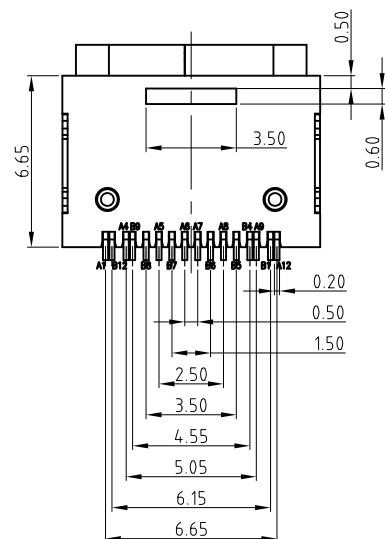
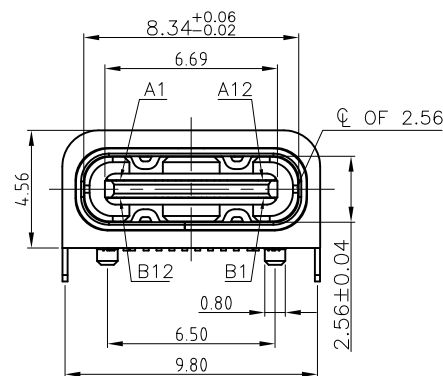
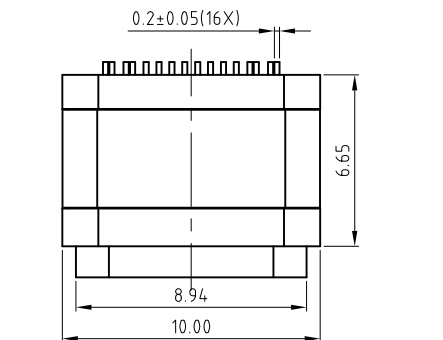
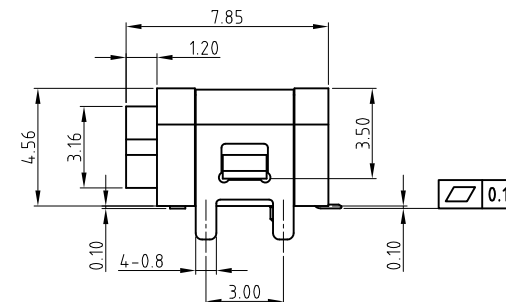
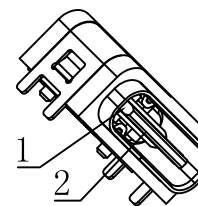
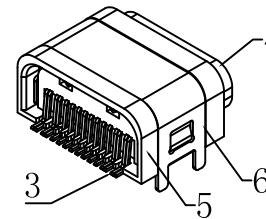

带防水圈示意图

6	支架	1	SUS 304 T=0.20	镀镍 50"
5	外套	1	LCP UL94V-0	黑色
4	铁壳	1	SUS 304 T=0.30	镀镍 30"
3	端子	1	C2680	半金镍 1u"
2	胶芯	1	LCP UL94V-0	黑色
1	中夹片	1	SUS 304 T=0.15	镀镍 30"
NO.	PART NAME	QTY.	MATERIAL	FINISH